

GS BATTERY VRLA BATTERY SPECIFICATION

Taiwan

電池型式 (BATTERY TYPE) : PE12V1.2

Dimensions : mm

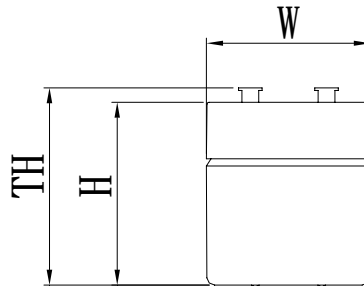
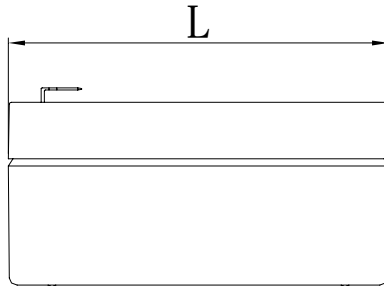
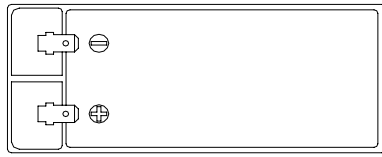

Terminal F1 : mm (inch)

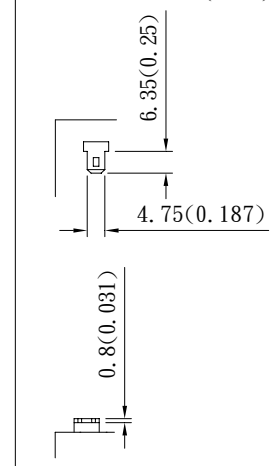

1.尺寸(Dimensions):

項目 (Item)	規格值 (Specifications)
1.長 (Length)	97±1 mm
2.寬 (Width)	42±1 mm
3.高 (Height)	51±1 mm
4.總高 (Total Height)	55±2 mm

2.性能測試 (Performance):

項目 (Item)	規格值 (Specifications)				
1.電壓 (Nominal Voltage)	12 V				
2.重量 (APPROX. Weight)	0.55 Kgs				
3.自行放電特性 Shelf Life (25°C)	1月 (1 Month)	97% ↑			
	3月 (3 Month)	90% ↑			
	6月 (6 Month)	80% ↑			
4.放電容量 ±5% (Discharge Capacity)	Discharge current	Final voltage	Discharge time	Capacity	
	20HR容量 (20hr Capacity)	0.06A	10.50 V	20hrs	1.2AH
	5HR容量 (5hr Capacity)	0.20A	10.20 V	5hrs	1.0AH
	3HR容量 (3hr Capacity)	0.28A	10.20 V	3hrs	0.8AH
	1HR容量 (1hr Capacity)	0.72A	9.60 V	1hrs	0.7AH

※電池經充、放電三次，容量達規格值95%。

(Battery capacity can reach 95% of Specification value after three cycles of charging and discharging.)

3. 定功率放電特性(Constant Power Discharge Characteris

※實測之一例，非保證值
 ※One example of our result, not announcement value.

Time F.V	5Min.	7.5Min.	10Min.	15Min.	20Min.	30Min.	60Min.
9.6 V	53 W	42 W	36 W	27 W	21 W	16 W	8 W
10.2 V	52 W	41 W	35 W	26 W	20 W	15 W	8 W
10.8 V	47 W	38 W	34 W	25 W	19 W	14 W	7 W

※實測之一例，非保證值
 ※One example of our result, not announcement value.

4. 性能特性圖(Characteristics)

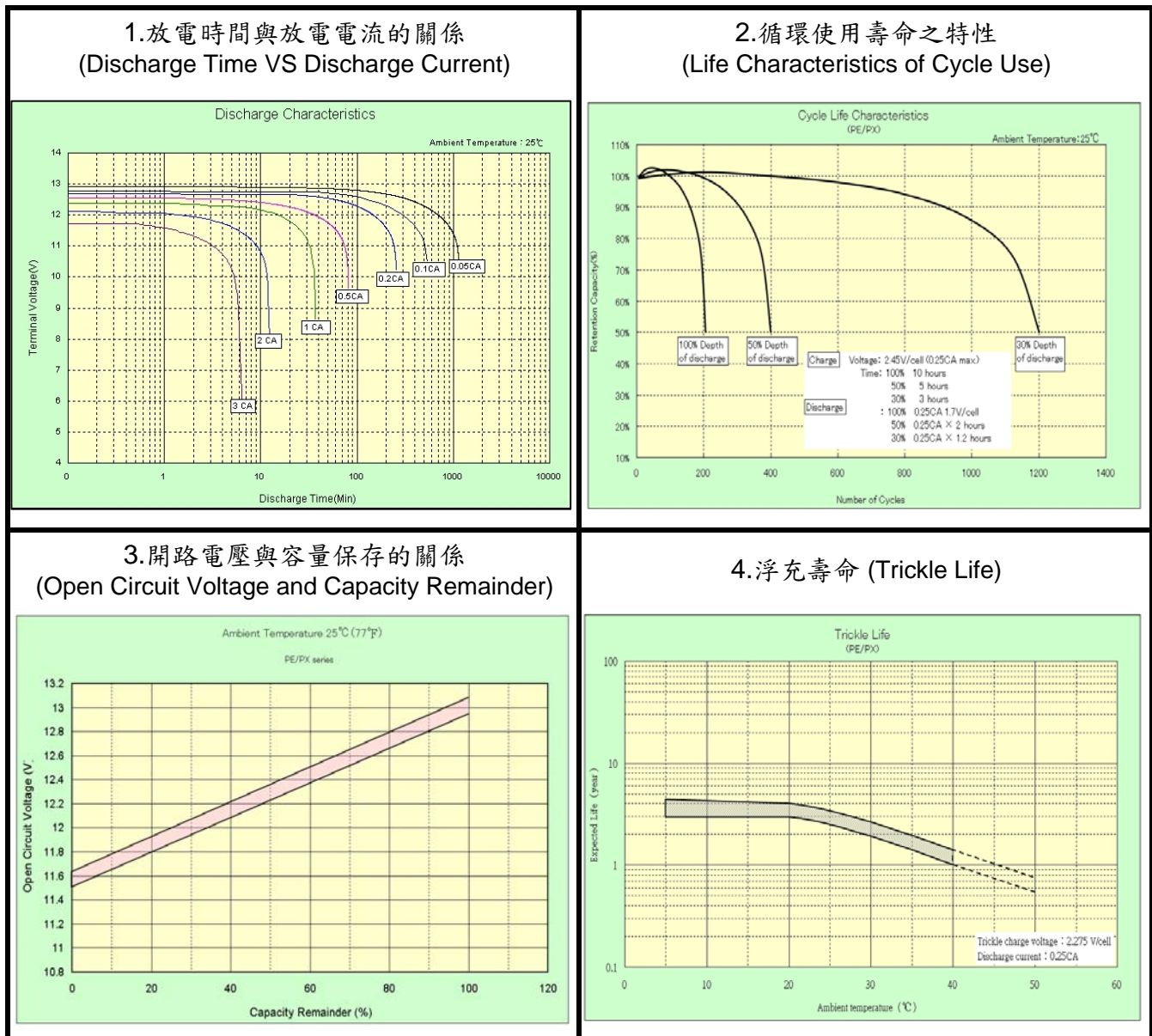

5. 國際認證(International Certification)

- (1).ISO 9001 , QS9000 , TS16949
- (2).UL approval , Code : MH13567



台灣杰士電池工業股份有限公司
 71042台南市永康區中正北路999號
 電話:(06)253 2191(代表號)
 傳真:(06)253 5188 (06)254 9498(Expt)